

FOR LEASE

ALLGOOD 75 BUSINESS PARK

850

PICKENS INDUSTRIAL DRIVE | SUITES E & F

Marietta, GA 30067



BUILDING SPECIFICATIONS

- + 22,125 SF available
- + 3,378 SF office
- + Total building size: 88,505 SF
- + 2 dock high doors; 2 drive-in doors
- + 20' clear height
- + 177'-8 1/2" building depth
- + Easy access to I-75 and I-285
- + Surrounded by a skilled labor force and located in an Opportunity Zone, providing job tax credits of \$3,500/qualified job/year

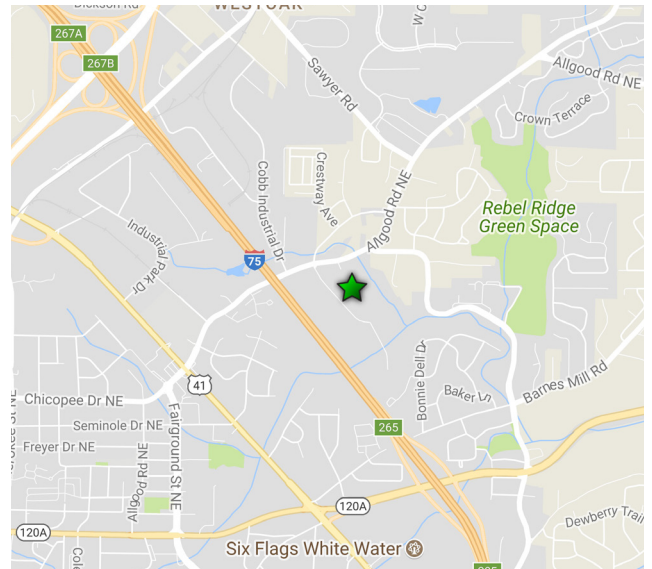

CONTACT US

JOANNA MATHER

Associate
404 812 5021
joanna.mather@cbre.com

TODD BARTON, SIOR

First Vice President
404 923 1435
todd.barton@cbre.com



www.cbre.com/atlanta

CBRE

FOR LEASE
ALLGOOD 75

850
PICKENS INDUSTRIAL DRIVE
SUITES E & F
Marietta, GA 30067



FLOOR PLAN

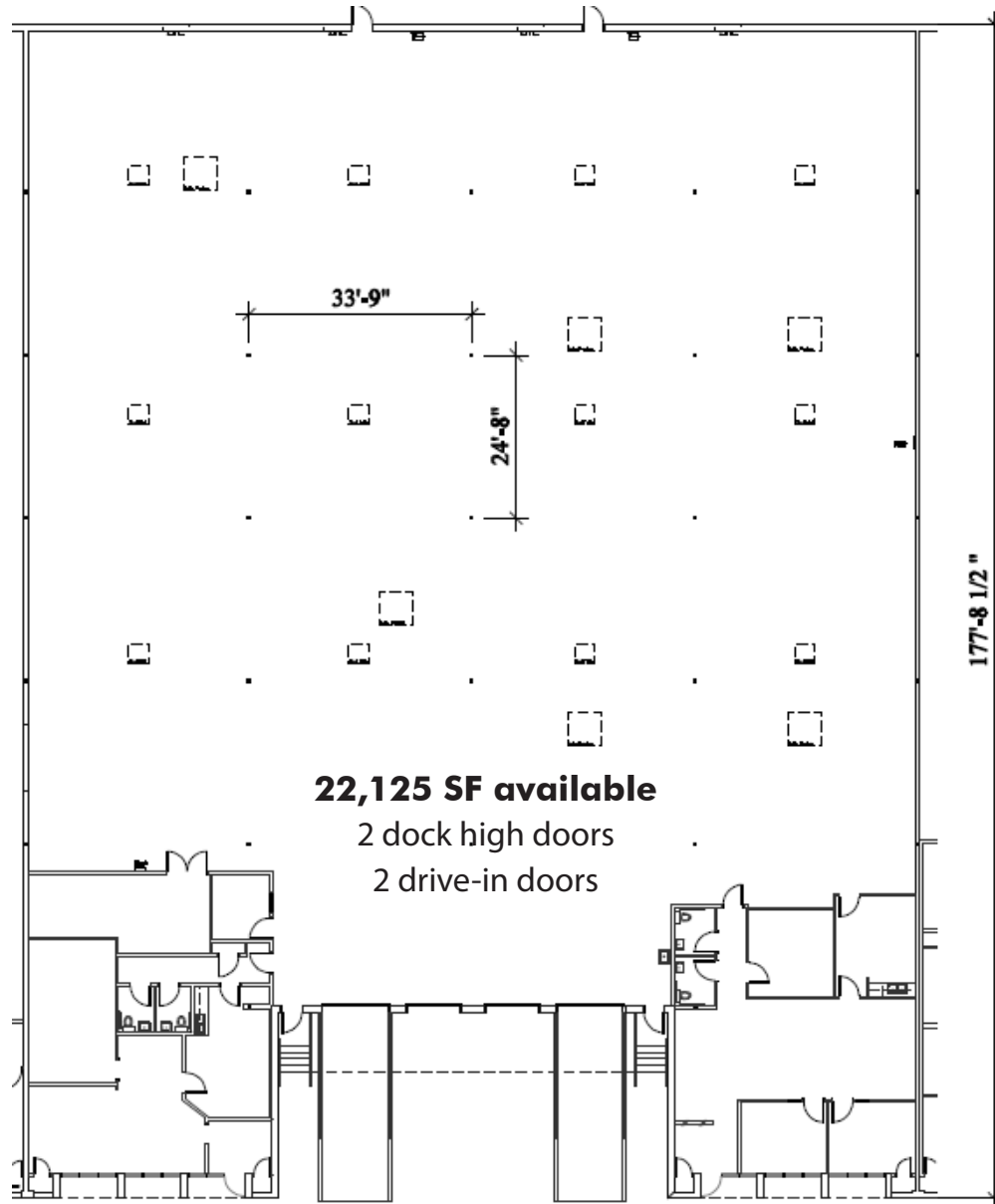

© 2018 CBRE, Inc. All rights reserved. This information has been obtained from sources believed reliable, but has not been verified for accuracy or completeness. Any projections, opinions, or estimates are subject to uncertainty. The information may not represent the current or future performance of the property. You and your advisors should conduct a careful, independent investigation of the property and verify all information. Any reliance on this information is solely at your own risk. CBRE and the CBRE logo are service marks of CBRE, Inc. and/or its affiliated or related companies in the United States and other countries. All other marks displayed on this document are the property of their respective owners. Photos herein are the property of their respective owners and use of these images without the express written consent of the owner is prohibited.