

Ramp Requirements (ADA)

RAMP REQUIREMENTS

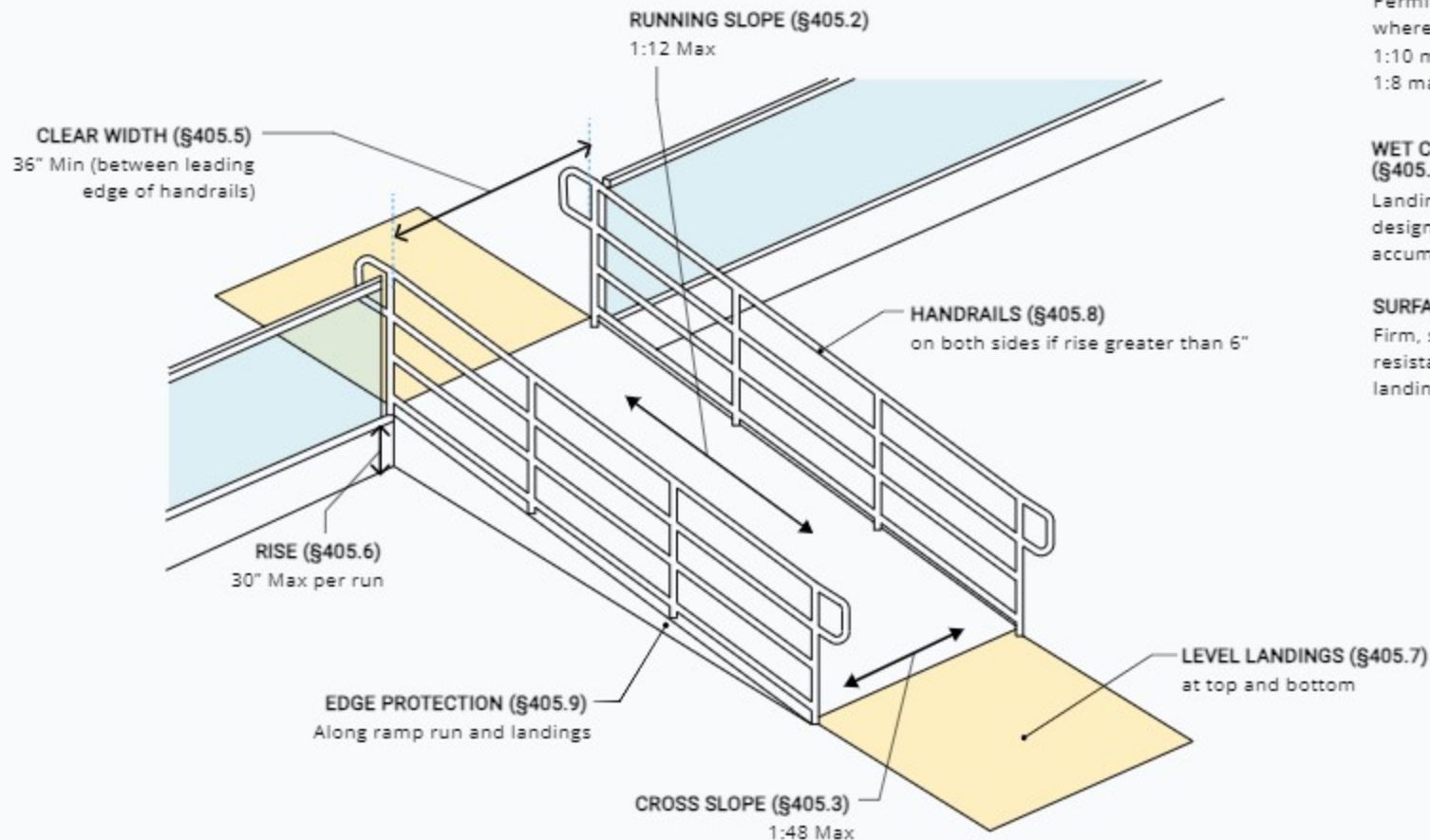

ALTERATIONS (§405.2)

Permitted running slopes where space is limited, 1:10 max (6" max rise) or 1:8 max (3" max rise)

WET CONDITIONS (§405.10)

Landings must be designed to prevent the accumulation of water

SURFACES (§405.4)

Firm, stable, and slip-resistant (run and landing surfaces)